

Technical drawing of a vertical rod assembly. The drawing shows a central vertical rod with several fittings and dimensions. Key dimensions include: a top flange with a diameter of $\varnothing 45$ and a height of 55; a side fitting with a diameter of $\varnothing 57$ and a height of 70; a bottom fitting with a diameter of $\varnothing 26$ and a height of 30-40; a central rod with a diameter of $\varnothing 10$ and a length of approximately 360; a side fitting with a diameter of $\varnothing 63$ and a height of max.52; and a bottom fitting with a diameter of $\varnothing 40$ and a height of max.180. The drawing also shows various thread specifications: $G\frac{1}{2}$, $G\frac{3}{8}$, and $G1\frac{1}{4}$.

24 651 LG0 SINFONIA BATTERIA A TRE FORI PER BIDET

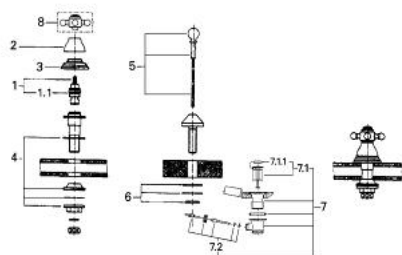

PARTI DI RICAMBIO , gennaio 1992 – now

1: Testina in ceramica da 1/2" (Ordine n. 45346000)

1.1: O-ring Ø 18,2 x Ø 1,7 (Ordine n. 0392400M)

2: Cappuccio (Ordine n. 45700L00)

3: Rosetta (Ordine n. 45692G00)

4: Gruppo di serraggio astina (Ordine n. 45706000)

5: Astina a saltarello (Ordine n. 45707LG0)

6: Gruppo di serraggio astina (Ordine n. 45708000)

7: Piletta di scarico completa con tappo circolare, asta a snodo e raccordo con viti di bloccaggio (Ordine n. 28910LG0)

7.1: Tappo (Ordine n. 07182G00)

7.1.1: Guarnizione (Ordine n. 0506500M)

7.2: Asta eccentrica (Ordine n. 07052000)

8: Manopola a croce (Ordine n. 45600LG0)*

* Accessori speciali