

Technical drawing of a vertical support structure. The drawing shows a central vertical rod with a diameter of $\varnothing 45$. At the top, there are two horizontal mounting brackets. The left bracket has a height of 70 and a diameter of $\varnothing 57$. The right bracket has a height of 55 and a diameter of $\varnothing 26$. The distance between the centers of these two brackets is 30-40. The central rod has a height of approximately 360. At the bottom, there is a horizontal base plate with a diameter of $\varnothing 63$ and a height of max. 52. The base plate is mounted on a vertical support with a diameter of $\varnothing 40$. The base plate has a height of max. 180. The central rod is connected to the base plate via a joint with a diameter of $G \frac{1}{2}$ and a height of max. 180. The base plate is also connected to a vertical support with a diameter of $G \frac{1}{4}$ and a height of max. 180.

- Colore: cromo

24 651 000 SINFONIA BATTERIA A TRE FORI PER BIDET

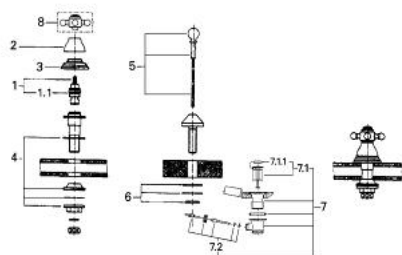

PARTI DI RICAMBIO , gennaio 1992 – now

1: Testina in ceramica da 1/2" (Ordine n. 45346000)

1.1: O-ring Ø 18,2 x Ø 1,7 (Ordine n. 0392400M)

2: Cappuccio (Ordine n. 45700000)

3: Rosetta (Ordine n. 45692000)

4: Gruppo di serraggio astina (Ordine n. 45706000)

5: Testa astina a saltarello (Ordine n. 04425000)

6: Gruppo di serraggio astina (Ordine n. 45708000)

7: Piletta di scarico completa con tappo circolare, asta a snodo e raccordo con viti di bloccaggio (Ordine n. 28910000)

7.1: Tappo (Ordine n. 07182000)

7.2: Asta eccentrica (Ordine n. 07052000)

8: Manopola a croce (Ordine n. 45600000)*

* Accessori speciali