

19 869 000 EUROPLUS C SINGLE FUNCTION THERMOSTATIC TRIM WITH CONTROL MODULE

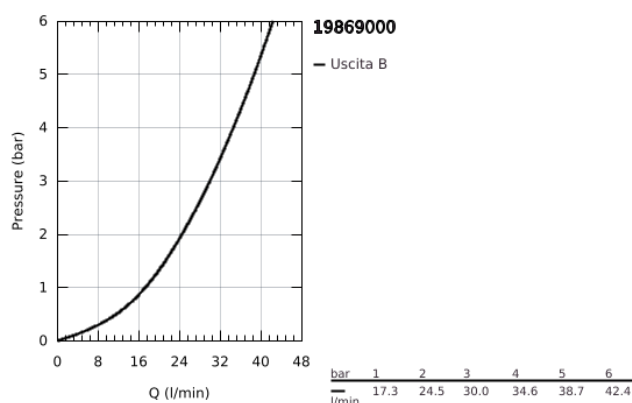

DESCRIZIONE PRODOTTO

- Colore: cromo
- for shower only or shower/tub with diverter applications
- GROHE TurboStat technology
- integrated volume control
- integrated bypass option when used with diverter tub spout
- 1 axis operation
- for use with GrohFlex universal rough-In box 35 026 000 sold separately
- code compliance:
- - ASME/ANSI A112.18.1M
- - CSA Standard B125.1-05



19 869 000 EUROPLUS C SINGLE FUNCTION THERMOSTATIC TRIM WITH CONTROL MODULE

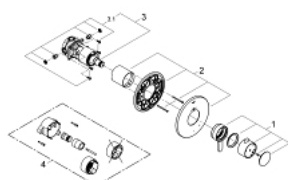

PARTI DI RICAMBIO , settembre 2010 – now

1: leva US (Ordine n. 47871000)

2: rosetta US (Ordine n. 47872000)

3: unità di comando THM Kit #1 (Ordine n. 47850000)

3.1: dispositivo anti-riflusso (Ordine n. 47851000)

4: Prolunga (Ordine n. 47822000)*

* Accessori speciali